

1216062.174 (LONG VERSION W/SPIRAL) 1216062.175 (LONG VERSION W/O SPIRAL)
 1216062.176 (MEDIUM VERSION W/SPIRAL) 1216062.177 (MEDIUM VERSION W/O SPIRAL)
 1216062.184 (SHORT VERSION W/O SPIRAL)
K CUP ADAPTER INSTALLATION KIT



NOTE: Read entire instructions before proceeding to install kit

KIT CONTENTS:		
PART NUMBER	QTY	DESCRIPTION
1218199.000330 1218199.001330 1218199.002330	1	K CUP ADAPTER - LONG K CUP ADAPTER - MEDIUM K CUP ADAPTER - SHORT
4200272.131309 (LONG) 4211397.001309 (MEDIUM)	1	10ct. CANDY SPIRAL (LONG KIT) optional 8ct. CANDY SPIRAL (MEDIUM KIT) optional (kits 1216062.174 & .176 with spiral) (kits 1216062.175 & .177 & .184 w/o spiral)
4212505	1	SCREW (fastened into Hub)
4050202.001	4	#8 SELF-DRILLING SCREWS
4219241	1	K Cup Adapter Kit Installation Instructions

TOOLS REQUIRED
1/8" drill bit and drill or 1/4" driver in powered screw gun
Phillips (#2) screwdriver or screw gun with Phillips bit

SAFETY WARNING: ALWAYS TURN POWER OFF BEFORE SERVICING MACHINE

- See table below to identify desired kit – refer to indicated pages for installation instructions
- Cut the top of a K Cup product leaving enough of the container to fit tight into the front of the K CUP ADAPTER (See Fig. 1 below)
- Load product and test vend. (See Fig. 2 below)

(NOTICE: Care must be taken when loading product and replacing the tray into the machine. All K Cup containers must be set upright with the base of the product on the load surface of the K CUP ADAPTER channel. If containers are not vertical or are tipped the product may jam during the vend.

KIT DESCRIPTION:			
MACHINE BRAND	KIT #	SPIRAL LENGTH	INSTRUCTION PAGE #
U SELECT-IT (USI)	1216062.174	10 CT.	2
	1216062.175		
U SELECT-IT (USI)	1216062.176	8 CT.	2
	1216062.177		
AUTOMATED MERCHADISING SYSTEMS (AMS)	1216062.175	10 CT.	3
AUTOMATIC PRODUCTS (DEEP DEPTH MODELS)	1216062.175	10 CT.	4
AUTOMATIC PRODUCTS (SHALLOW DEPTH MODELS)	1216062.177	6 CT.	4
CRANE/NATIONAL VENDORS (NV)	1216062.175	11 CT.	5
CRANE/NATIONAL VENDORS (NV)	1216062.184		5

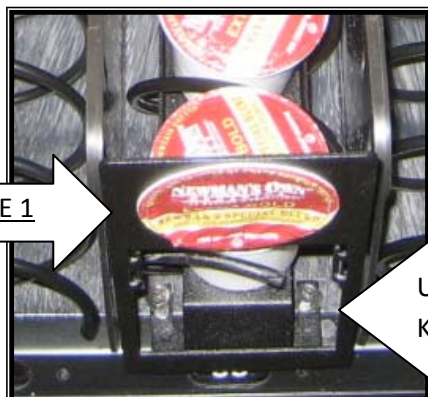

Figure 1

SEE NOTE 2 AND NOTICE NOTE
 ABOVE

USE 4050202.001 (2) TO FASTEN
 K CUP ADAPTER TO TRAY



Figure 2

Instructions for USI Equipment

BREAK TAB OFF (BY BENDING TAB BACK AND FORTH)
AT INDICATED LOCATION

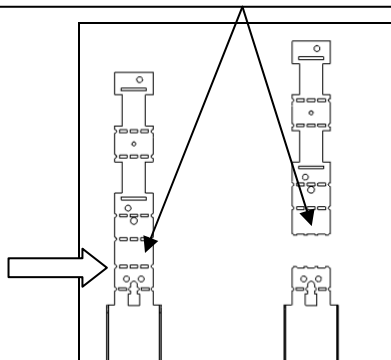

Figure 1

BEND TAB UP 90 DEGREES

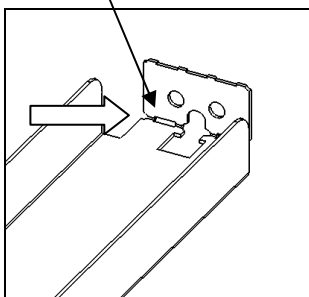

Figure 2

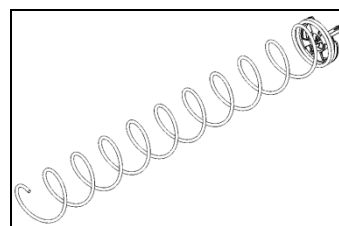

Figure 3

1. Break off tab at indicated location (See Fig. 1)
2. Form tab up 90 degrees (See Fig. 2)
3. Remove spiral and hub out of the selection (See Fig. 3)
4. Detach hub from the spiral

RE-INSTALL SPIRAL
POSITION INTO MOTOR @
12 O'CLOCK

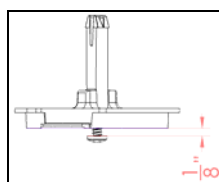

Figure 4

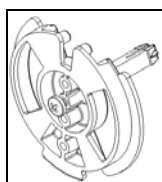

Figure 5

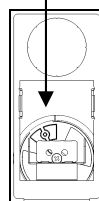

Figure 6

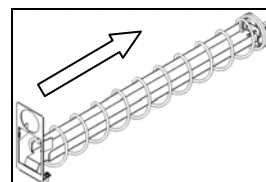

Figure 7

5. Use provided fastener **4212505** and install into the back of hub as shown (See Fig. 4) & (See Fig. 5)
(Do not fasten **4212505** all the way down to hub, leave
An 1/8" gap between hub and 4212505 Back of screw head (See Fig. 4)
6. Attach the hub back onto the spiral
7. Re-Install the spiral back into the tray selection at 12 o'clock position as shown (See Fig. 6)
8. Install the **K-Cup adapter** through the spiral (See Fig. 7)

USE FASTENER 4050202.001 TO FASTEN
K-CUP ADAPTER TO TRAY

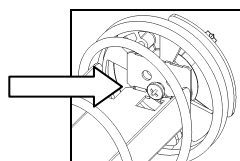

Figure 8

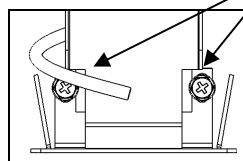

Figure 9

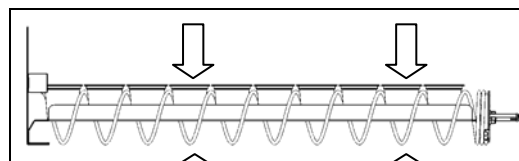

Figure 10

FROM THE BASE OF THE TRAY TO THE
TOP OF THE K-CUP SHOULD ALL BE
THE SAME HEIGHT

9. Hook tab of adapter over screw head as shown (See Fig. 8)
10. Use provided screws (**4050202.001** (2)) to fasten the **K-Cup adapter** to the tray (See Fig. 9)
11. From the base of the tray to the top of the K-Cup should all be at the same height (See Fig. 10)

KIT DESCRIPTION:			
MACHINE BRAND	KIT #	SPIRAL LENGTH	WITH OR WITHOUT SPIRAL
U SELECT-IT (USI)	1216062.174	10 CT.	WITH
U SELECT-IT (USI)	1216062.175	10 CT.	WITHOUT
U SELECT-IT (USI)	1216062.176	8 CT.	WITH
U SELECT-IT (USI)	1216062.177	8 CT.	WITHOUT

Instructions for AMS Equipment

KIT DESCRIPTION:			
MACHINE BRAND	KIT #	SPIRAL LENGTH	WITH OR WITHOUT SPIRAL
AUTOMATED MERCHANDISING SYSTEMS (AMS)	1216062.175	10 CT.	WITHOUT

BREAK TAB OFF (BY BENDING TAB BACK AND FORTH)
AT INDICATED LOCATION

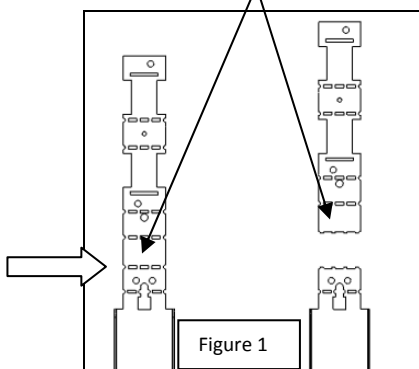

BEND TAB UP 90 DEGREES

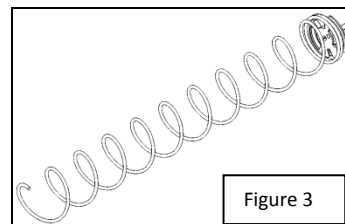
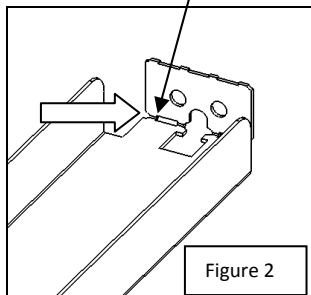

1. Break off tab at indicated location (See Fig. 1)
2. Form tab up 90 degrees (See Fig. 2)
3. Remove spiral and hub out of the selection (See Fig. 3)
4. Detach hub from the spiral

RE-INSTALL SPIRAL
POSITION INTO MOTOR
@ 12 O'CLOCK

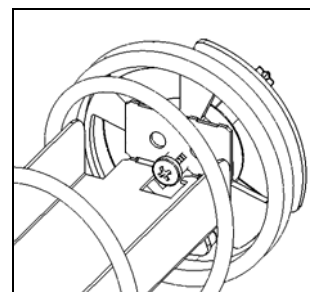
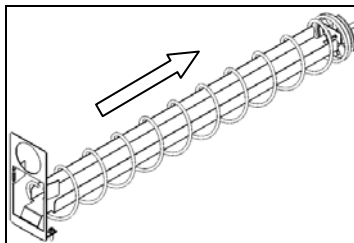
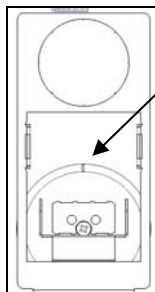
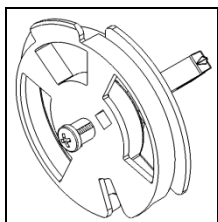

5. Use provided fastener **4212505** and install flush into the hub (See Fig. 4)
6. Attach the hub back onto the spiral
7. Re-Install the spiral back into the tray selection at 12 o'clock position as shown (See Fig. 5)
8. Install the **K-Cup adapter** through the spiral (See Fig. 6)
9. Hook tab of adapter over screw head as shown (See Fig. 7)

USE FASTENER 4050202.001 TO
FASTEN K-CUP ADAPTER TO TRAY

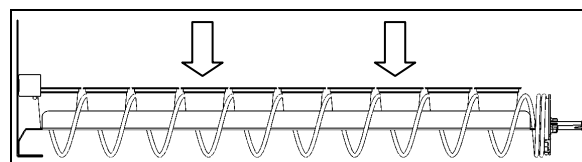
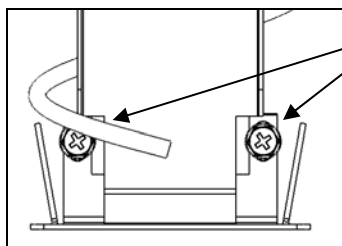

10. Use provided screws (**4050202.001** (2)) to fasten the **K-Cup adapter** to the tray (See Fig. 8)
11. From the base of the tray to the top of the K-Cup should all be at the same height (See Fig. 9)

FROM THE BASE OF THE TRAY TO THE
TOP OF THE K-CUP SHOULD ALL BE
THE SAME HEIGHT

Instructions for AP Equipment

BREAK TAB OFF (BY BENDING TAB BACK AND FORTH)
AT INDICATED LOCATION

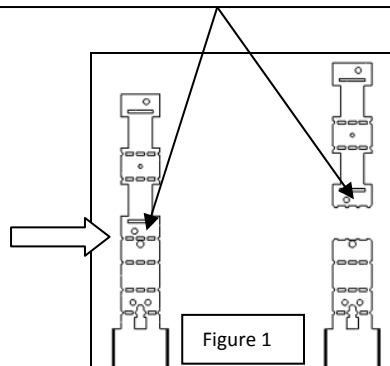

Figure 1

BEND TAB DOWN 90 DEGREES

BEND TAB UP 90 DEGREES

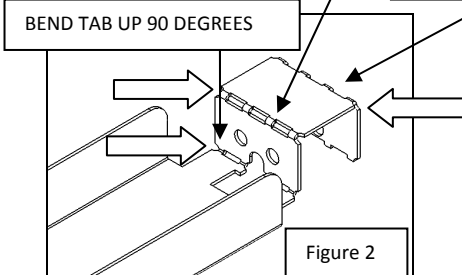

Figure 2

BEND TAB DOWN 90 DEGREES

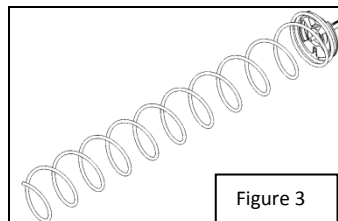

Figure 3

1. Break off tab at indicated location (See Fig. 1)
2. Form tab up 90 degrees, then bend tab down 90 degrees, finally bend the last tab down 90 degrees (See Fig. 2)
3. Remove spiral and hub out of the selection (See Fig. 3)

RE-INSTALL SPIRAL
POSITION INTO MOTOR@
12 O'CLOCK

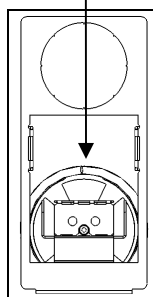

Figure 4

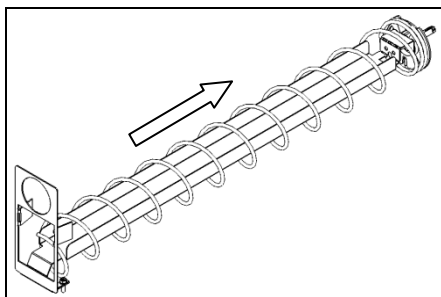

Figure 5

PUSH ADAPTER HOLE OVER HUB
PROTRUSION

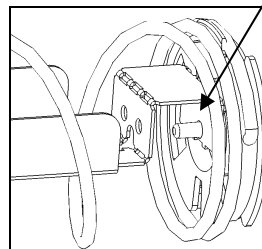

Figure 6

4. Install the spiral back into the tray selection at 12 o'clock (See Fig. 4)
5. Install the **K-Cup adapter** through the spiral (See Fig. 5)
6. Push adapter hole over hub protrusion as shown (See Fig. 6)

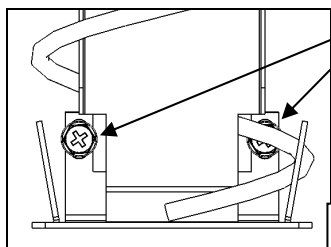

Figure 7

USE FASTENER 4050202.001 TO
FASTEN K-CUP ADAPTER TO TRAY

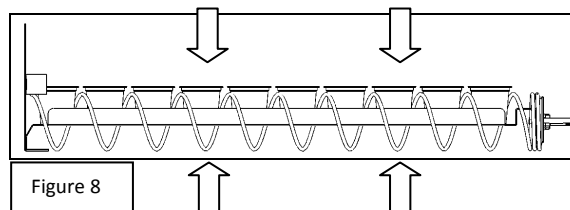

Figure 8

FROM THE BASE OF THE TRAY TO THE
TOP OF THE K-CUP SHOULD ALL BE
THE SAME HEIGHT

7. Use provided screws (**4050202.001** (2)) to fasten the **K-Cup adapter** to the tray (See Fig. 7)
8. From the base of the tray to the top of the K-Cup should all be at the same height (See Fig. 8)

Instructions for National Equipment

KIT DESCRIPTION:

MACHINE BRAND	KIT #	SPIRAL LENGTH	WITH OR WITHOUT SPIRAL
CRANE/NATIONAL VENDORS (NV)	1216062.175	11 CT.	WITHOUT
CRANE/NATIONAL VENDORS (NV)	1216062.184	10 CT.	WITHOUT

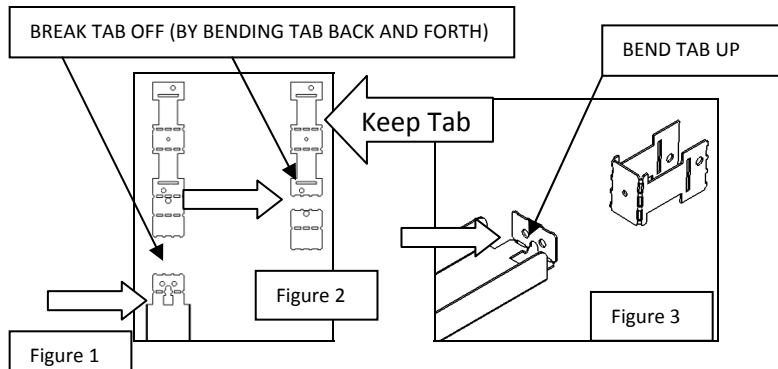

1. Break off tab of K-Cup adapter at indicated location (See Fig. 1)
2. Break off tab of detached bracket, keep end bracket for use later (See Fig. 2)
3. Form tab up 90 degrees on k-cup adapter (See Fig. 3)
4. Remove spiral and hub out of the selection (See Fig. 4)

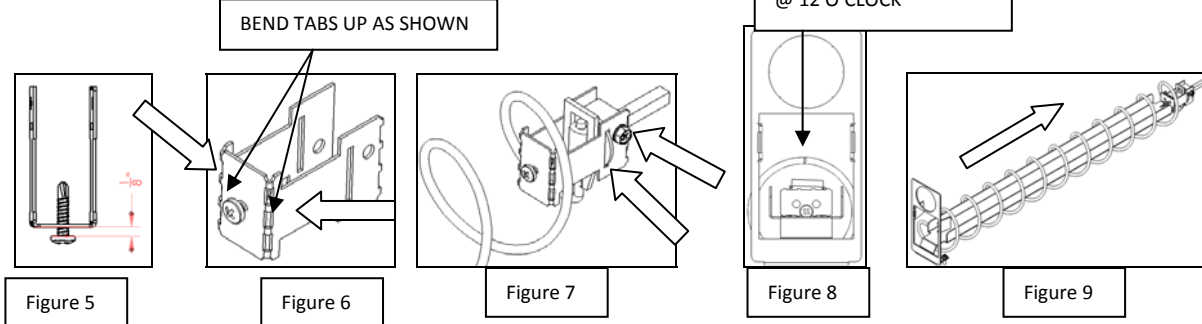
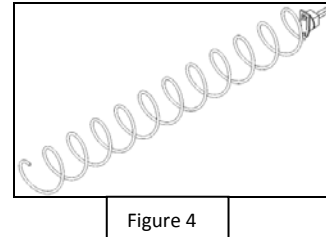

5. Use provided fastener **4212505** and install in the back of bracket (See Fig. 5 & 6)
(Do not fasten 4212505 all the way down to bracket, leave An 1/8" gap between the bracket and 4212505) (See Fig. 5)
6. Form the bracket 90 degrees both sides (See Fig. 5 & 6)
7. Attach bracket to hub, with sides of hub in rectangles of bracket (See Fig. 7)
8. Use provided fastener **4050202.001** (2) in holes of bracket, through hub, to securely fasten bracket to hub (See Fig. 7)
9. Re-Install the spiral back into the tray selection at 12 o'clock position as shown (See Fig. 8)
10. Install the **K-Cup adapter** through the spiral (See Fig. 9)

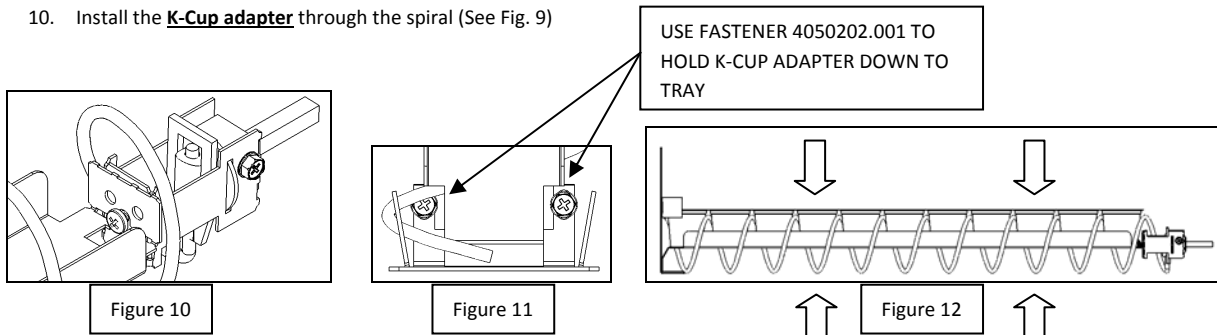

11. Hook tab of adapter over screw head as shown (See Fig. 10)
12. Use provided screws (**4050202.001** (2)) to fasten the **K-Cup adapter** to the tray (See Fig. 11)
13. From the base of the tray to the top of the K-Cup should all be at the same height (See Fig. 12)